



Windows and sliding doors

SERIE KRISTAL

Categories

	Window	Door
Air permeability EN 1026	Class 2	Class 3
Water tightness EN 1027	Class 7A	Class 6A
Wind resistance EN 12211	Class C5	Class C2

Categories reached for maneuvering forces (EN12046):

- Release the hardware lock: Class 2
- Leaf opening: Class 1
- Closing sheet: Class 1
- Closing hardware hook: Class 2

\* Uw thermal transmittance: 1.29 (W / m2.k)

\* Acoustic attenuation: 41dB

(\* According to type of glass.)

Colors

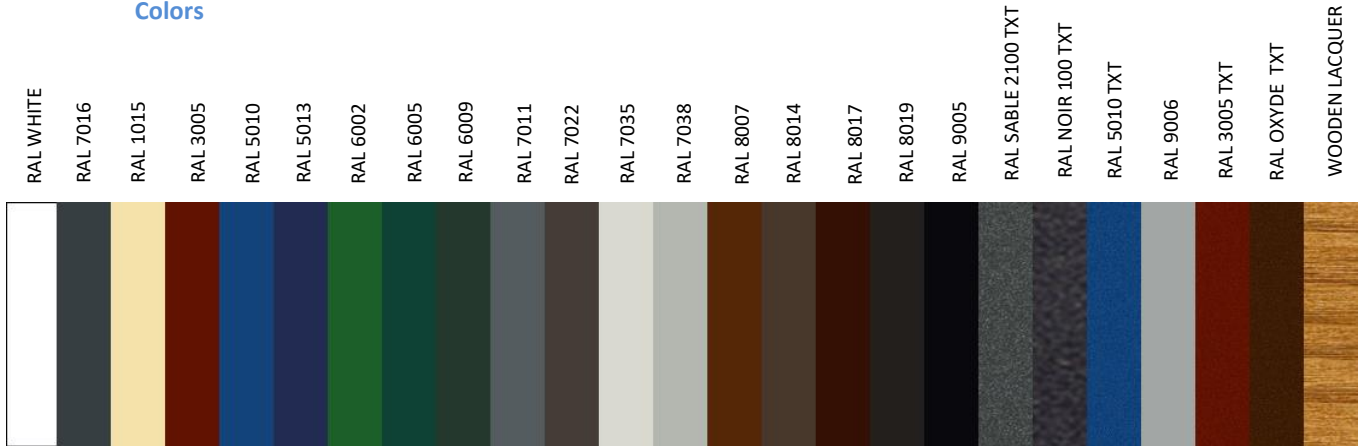

\* Colors may vary, check with us the variety of colors available.

Detailed section

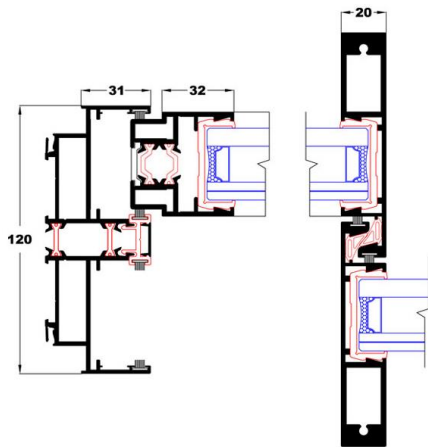

Types of opening

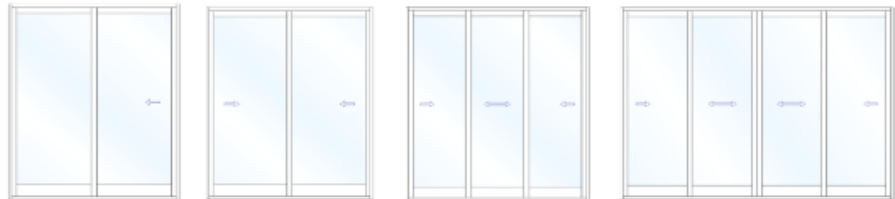

\* Possibility of opening at an angle.

Sections

Frame: 120mm bi-rail

Glazed

Maximum 32mm

